

# Saw Tips

Argensinter standard

---



## Saw Tips

(according to Argensinter Standard)

Page 2 of 5

### Type: SA

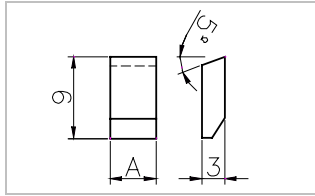

| Code | A   |
|------|-----|
| SA3  | 3   |
| SA35 | 3.5 |
| SA4  | 4   |
| SA45 | 4.5 |
| SA5  | 5   |

### Type: SB

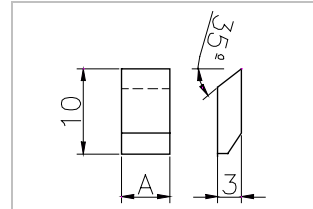

| Code | A   |
|------|-----|
| SB3  | 3   |
| SB35 | 3.5 |
| SB4  | 4   |
| SB45 | 4.5 |
| SB5  | 5   |

### Type: SC

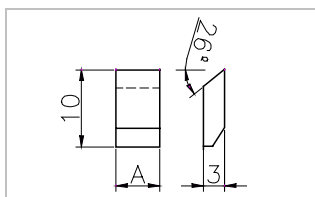

| Code | A   |
|------|-----|
| SC3  | 3   |
| SC35 | 3.5 |
| SC4  | 4   |
| SC45 | 4.5 |
| SC5  | 5   |

### Type: SD

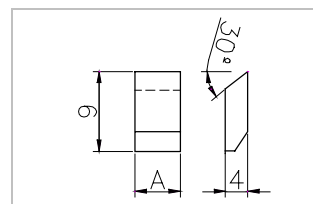

| Code | A   |
|------|-----|
| SD3  | 3   |
| SD35 | 3.5 |
| SD4  | 4   |
| SD45 | 4.5 |
| SD5  | 5   |

### Type: SE

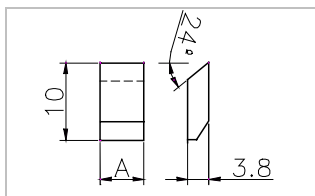

| Code | A   |
|------|-----|
| SE3  | 3   |
| SE35 | 3.5 |
| SE4  | 4   |
| SE45 | 4.5 |
| SE5  | 5   |

### Type: SF

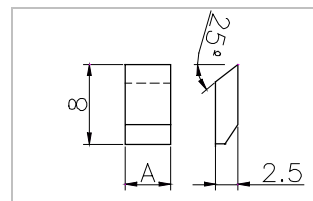

| Code | A   |
|------|-----|
| SF3  | 3   |
| SF35 | 3.5 |
| SF4  | 4   |
| SF45 | 4.5 |
| SF5  | 5   |

### Type: SG

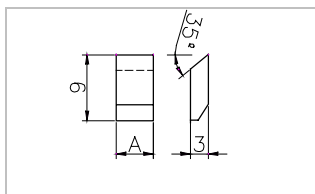

| Code | A   |
|------|-----|
| SG3  | 3   |
| SG35 | 3.5 |
| SG4  | 4   |
| SG45 | 4.5 |
| SG5  | 5   |

### Type: SH

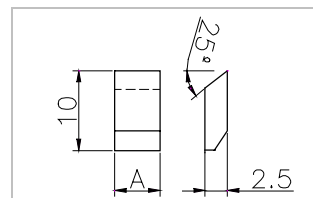

| Code | A   |
|------|-----|
| SH3  | 3   |
| SH35 | 3.5 |
| SH4  | 4   |
| SH45 | 4.5 |
| SH5  | 5   |

### Type: SJ

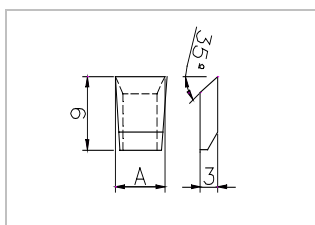

| Code | A   |
|------|-----|
| SJ3  | 3   |
| SJ35 | 3.5 |
| SJ4  | 4   |
| SJ45 | 4.5 |
| SJ5  | 5   |

### Type: SK

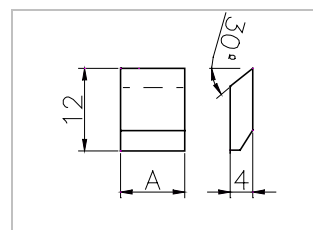

| Code  | A   |
|-------|-----|
| SK4   | 4   |
| SK4.5 | 4.5 |
| SK5   | 5   |
| SK5.5 | 5.5 |
| SK6   | 6   |
| SK6.5 | 6.5 |
| SK7   | 7   |
| SK7.5 | 7.5 |
| SK8   | 8   |
| SK8.5 | 8.5 |
| SK9   | 9   |
| SK9.5 | 9.5 |
| SK10  | 10  |

## Saw Tips

(according to Argensinter Standard)

Page 3 of 5

### Type: SK (continuación)

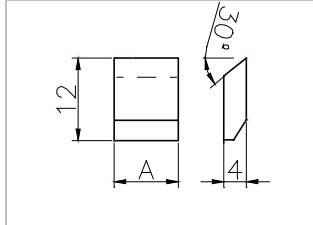

| Code   | A    | Code   | A    | Code   | A    | Code | A  |
|--------|------|--------|------|--------|------|------|----|
| SK10.5 | 10.5 | SK20.5 | 20.5 | SK30.5 | 30.5 | SK41 | 41 |
| SK11   | 11   | SK21   | 21   | SK31   | 31   | SK42 | 42 |
| SK11.5 | 11.5 | SK21.5 | 21.5 | SK31.5 | 31.5 | SK43 | 43 |
| SK12   | 12   | SK22   | 22   | SK32   | 32   | SK44 | 44 |
| SK12.5 | 12.5 | SK22.5 | 22.5 | SK32.5 | 32.5 | SK45 | 45 |
| SK13   | 13   | SK23   | 23   | SK33   | 33   | SK46 | 46 |
| SK13.5 | 13.5 | SK23.5 | 23.5 | SK33.5 | 33.5 | SK47 | 47 |
| SK14   | 14   | SK24   | 24   | SK34   | 34   | SK48 | 48 |
| SK14.5 | 14.5 | SK24.5 | 24.5 | SK34.5 | 34.5 | SK49 | 49 |
| SK15   | 15   | SK25   | 25   | SK35   | 35   | SK50 | 50 |
| SK15.5 | 15.5 | SK25.5 | 25.5 | SK35.5 | 35.5 | SK51 | 51 |
| SK16   | 16   | SK26   | 26   | SK36   | 36   | SK52 | 52 |
| SK16.5 | 16.5 | SK26.5 | 26.5 | SK36.5 | 36.5 | SK53 | 53 |
| SK17   | 17   | SK27   | 27   | SK37   | 37   | SK54 | 54 |
| SK17.5 | 17.5 | SK27.5 | 27.5 | SK37.5 | 37.5 | SK55 | 55 |
| SK18   | 18   | SK28   | 28   | SK38   | 38   | SK56 | 56 |
| SK18.5 | 18.5 | SK28.5 | 28.5 | SK38.5 | 38.5 | SK57 | 57 |
| SK19   | 19   | SK29   | 29   | SK39   | 39   | SK58 | 58 |
| SK19.5 | 19.5 | SK29.5 | 29.5 | SK39.5 | 39.5 | SK59 | 59 |
| SK20   | 20   | SK30   | 30   | SK40   | 40   | SK60 | 60 |

### Type: SL

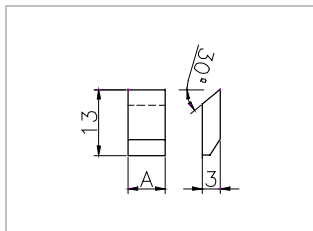

| Code | A   |
|------|-----|
| SL3  | 3   |
| SL35 | 3.5 |
| SL4  | 4   |
| SL45 | 4.5 |
| SL5  | 5   |

### Type: SM

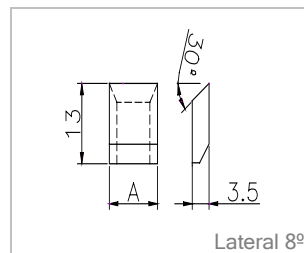

| Code | A  |
|------|----|
| SM4  | 4  |
| SM5  | 5  |
| SM6  | 6  |
| SM7  | 7  |
| SM8  | 8  |
| SM9  | 9  |
| SM10 | 10 |
| SM12 | 12 |
| SM15 | 15 |
| SM18 | 18 |
| SM20 | 20 |
| SM22 | 22 |
| SM25 | 25 |

### Type: SN

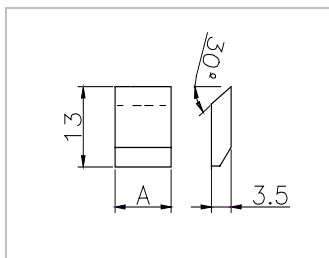

| Code | A  |
|------|----|
| SN4  | 4  |
| SN5  | 5  |
| SN6  | 6  |
| SN7  | 7  |
| SN8  | 8  |
| SN9  | 9  |
| SN10 | 10 |
| SN12 | 12 |
| SN15 | 15 |
| SN18 | 18 |
| SN20 | 20 |
| SN22 | 22 |
| SN25 | 25 |

### Type: SO

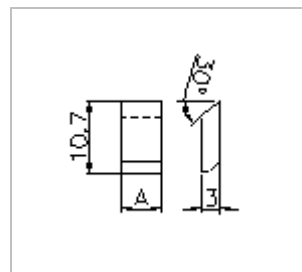

| Code | A   |
|------|-----|
| SO3  | 3   |
| SO35 | 3.5 |
| SO4  | 4   |
| SO45 | 4.5 |
| SO5  | 5   |

## Saw Tips

(according to Argensinter Standard)

Page 4 of 5

Type: SP

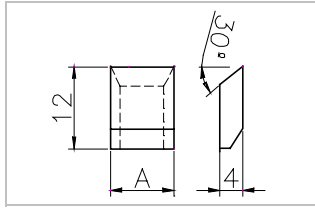

| Code | A  |
|------|----|
| SP4  | 4  |
| SP5  | 5  |
| SP6  | 6  |
| SP7  | 7  |
| SP8  | 8  |
| SP9  | 9  |
| SP10 | 10 |
| SP12 | 12 |
| SP15 | 15 |
| SP18 | 18 |
| SP20 | 20 |
| SP22 | 22 |
| SP25 | 25 |

For further information, please do not hesitate to contact us or visit our web site at [www.argensinter.com](http://www.argensinter.com)

Argensinter S.R.L. – Metal Duro y Herramientas Especiales  
Tacuarí 925 (B1704FJM) Ramos Mejía.  
Provincia of Buenos Aires, Argentina  
Tel.: (+54) 11 4658 7637 – Fax: (+54) 11 4656 8028  
email: [ventas@argensinter.com.ar](mailto:ventas@argensinter.com.ar) - Web site: <http://www.argensinter.com.ar>